

**La Rete prosegue SPECIFICHE: SCHEMA 3 «PONTE RADIO ESTERNO»**

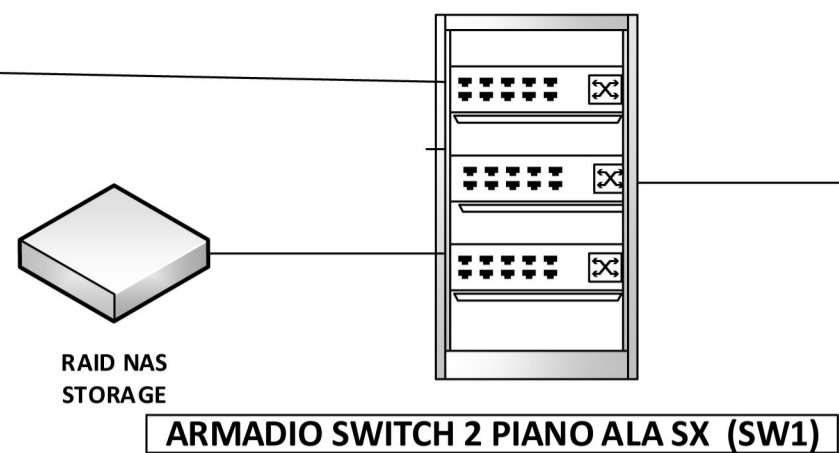

**SECONDO PIANO**

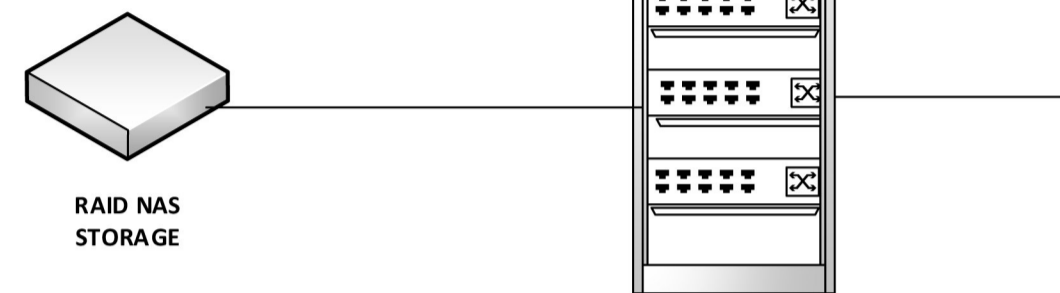
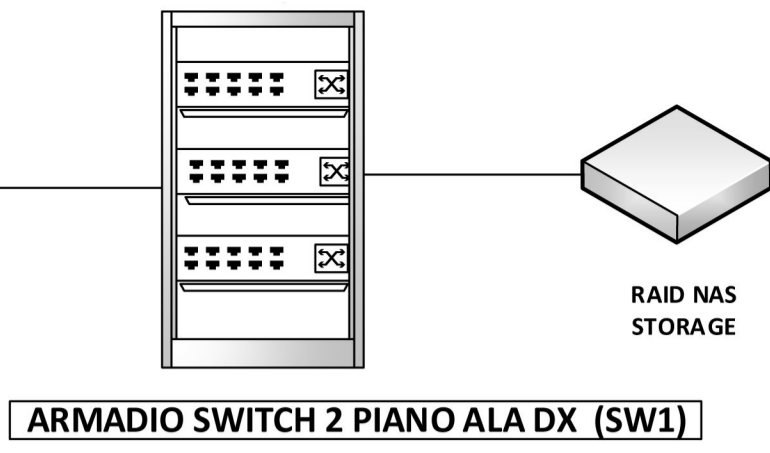

**PRIMO PIANO**

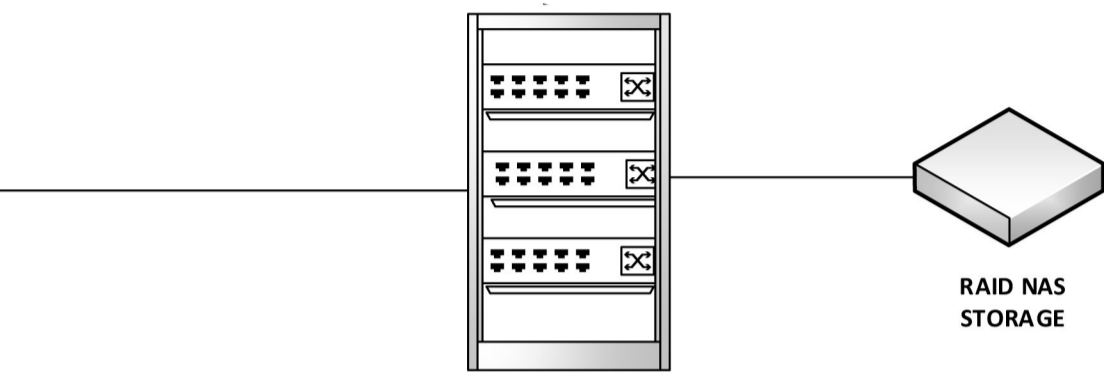

**La Rete prosegue SPECIFICHE: PLANIMETRIA 2 «PIANO TERRA ALA SX»**

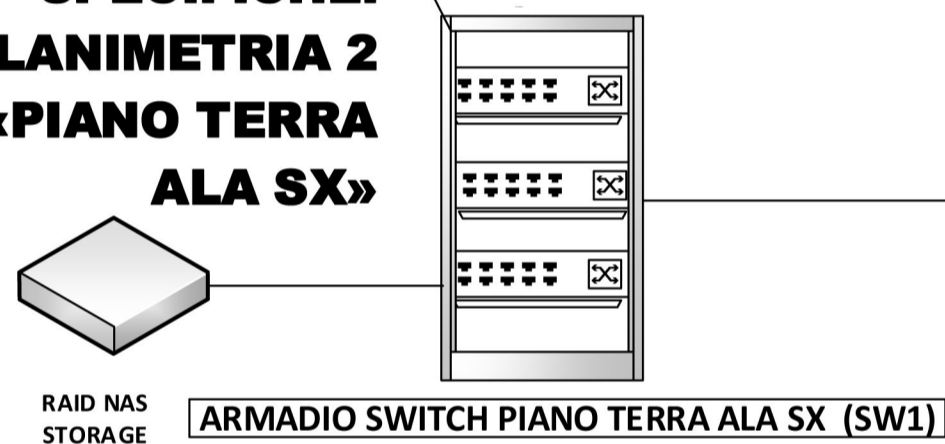

**PIANO TERRA**

**CORE SWITCH CENTRALE (CENTRO RETE) TOPOLOGIA RETE A STELLA**

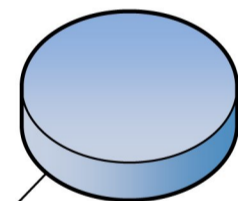

**La Rete prosegue SPECIFICHE: PLANIMETRIA 3 «PIANO TERRA ALA DX»**

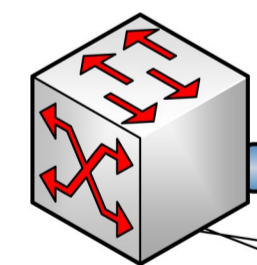

**C.E.D.**

Collegamento verso CED

**DORSALE FIBRA OTTICA**

**DORSALE FIBRA OTTICA**

**SWITCH DORSALE FIBRA OTTICA / ETHERNET NUM. 1 (CSW1)**

**SWITCH DORSALE FIBRA OTTICA / ETHERNET NUM. 2 (CSW2)**

PUNTI DI ACCESSO SX SALA POLIFUNZIONALE

PUNTI DI ACCESSO DX SALA POLIFUNZIONALE

**La Rete prosegue SPECIFICHE: PLANIMETRIA 1 «SEMINTERRATO»**

**La Rete prosegue SPECIFICHE: SCHEMA 2 «C.E.D.»**

**SEMINTERRATO**

**Schema n.1 Dorsale**

CONTENITORE DEL CED:  
ARMADIO RACK 42U

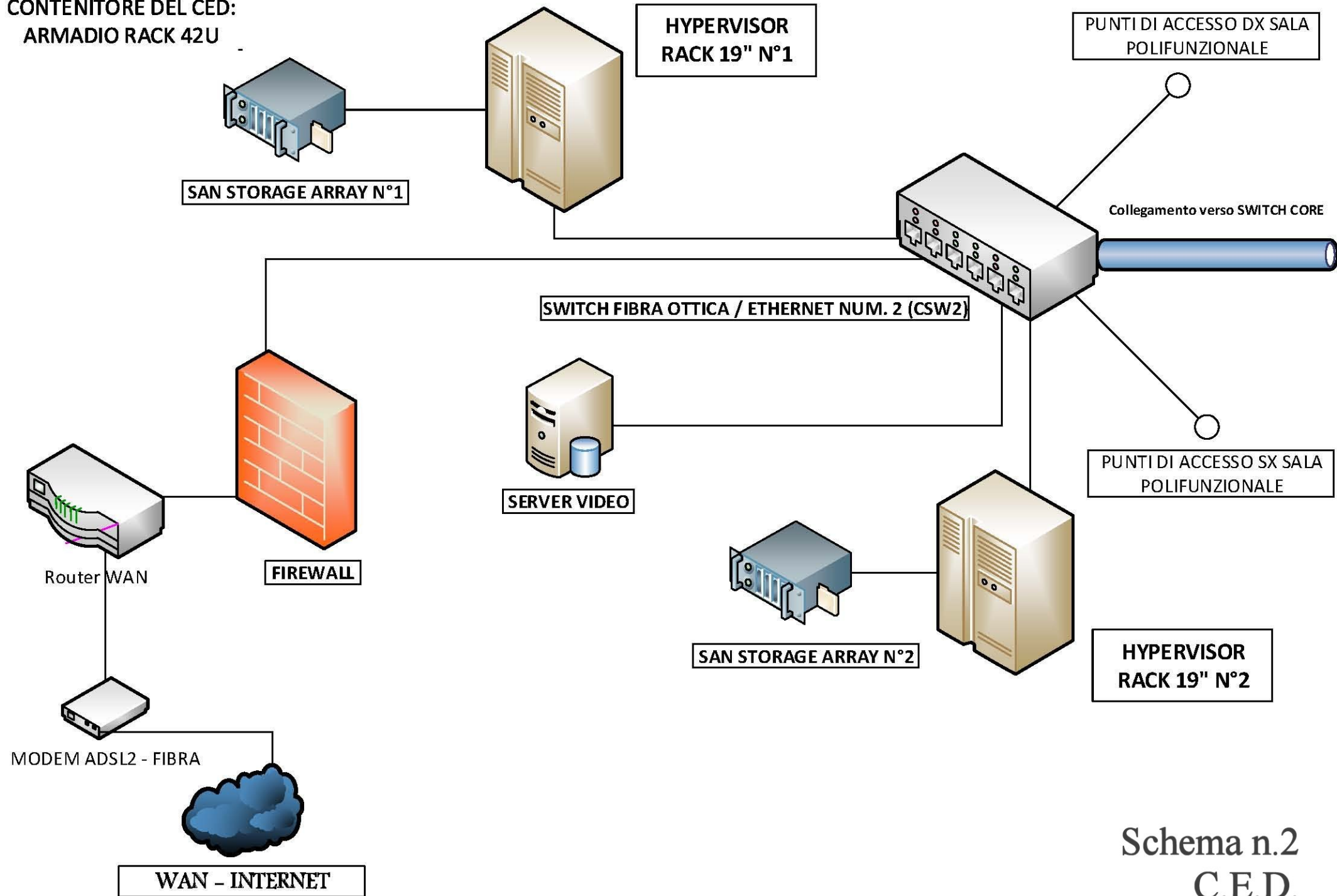

Schema n.2  
C.E.D.

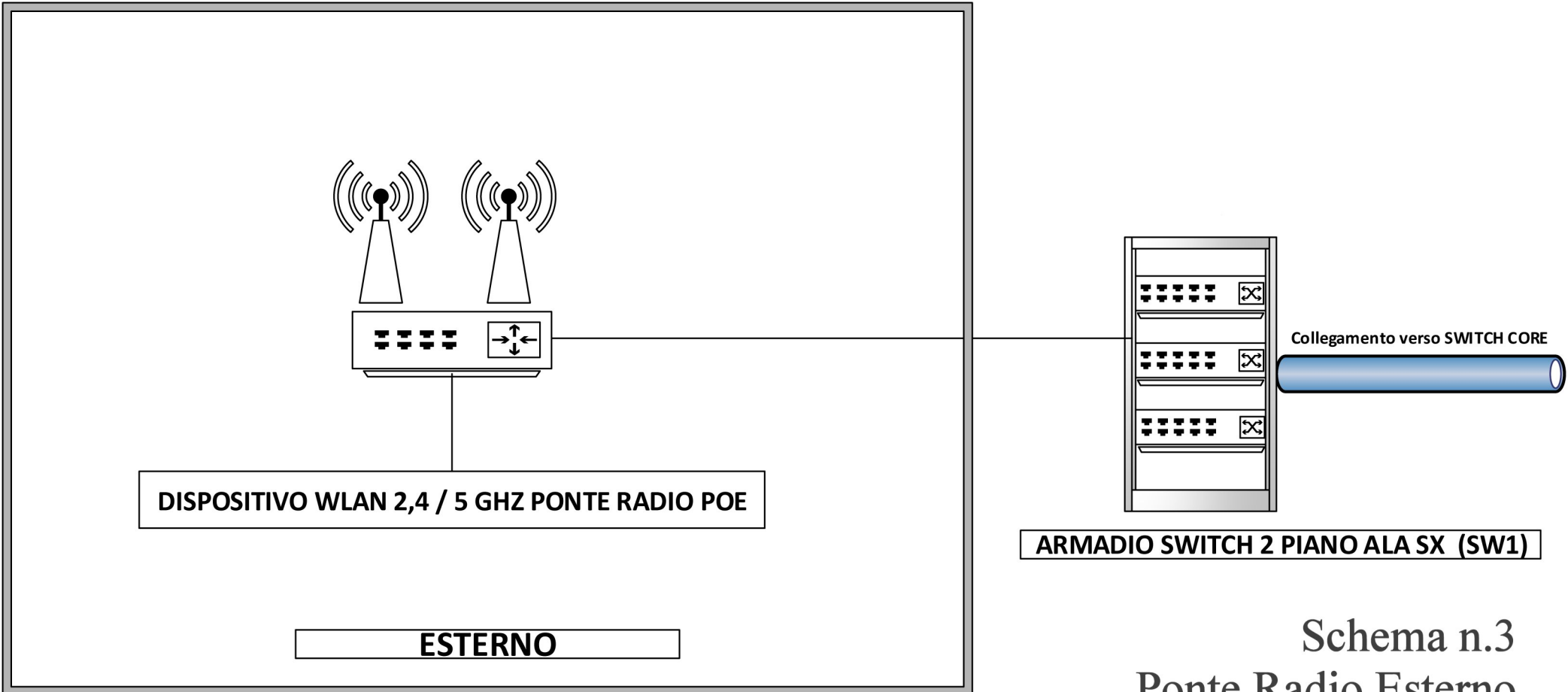

DISPOSITIVO WLAN 2,4 / 5 GHZ PONTE RADIO POE

ESTERNO

ARMADIO SWITCH 2 PIANO ALA SX (SW1)

Collegamento verso SWITCH CORE

Schema n.3  
Ponte Radio Esterno

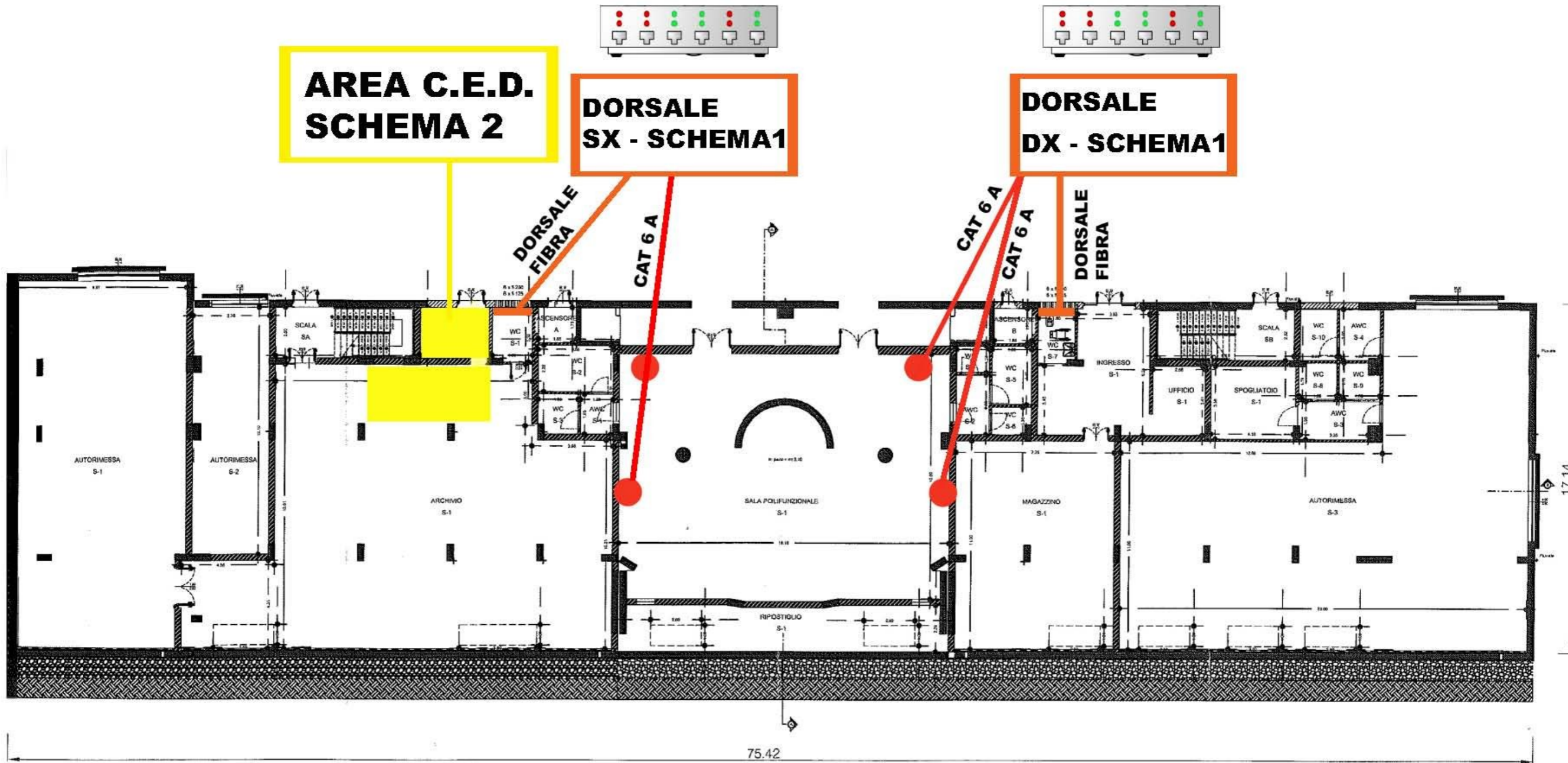

Planimetria Piano Seminterrato  
Rete lan e C.E.D.

CAT 6 A

ARMADIO SWITCH PIANO TERRA ALA SX

SWITCH 24 PORTE  
ETHERNET 10/100/1000  
CON UPLINK FIBRA OTTICA

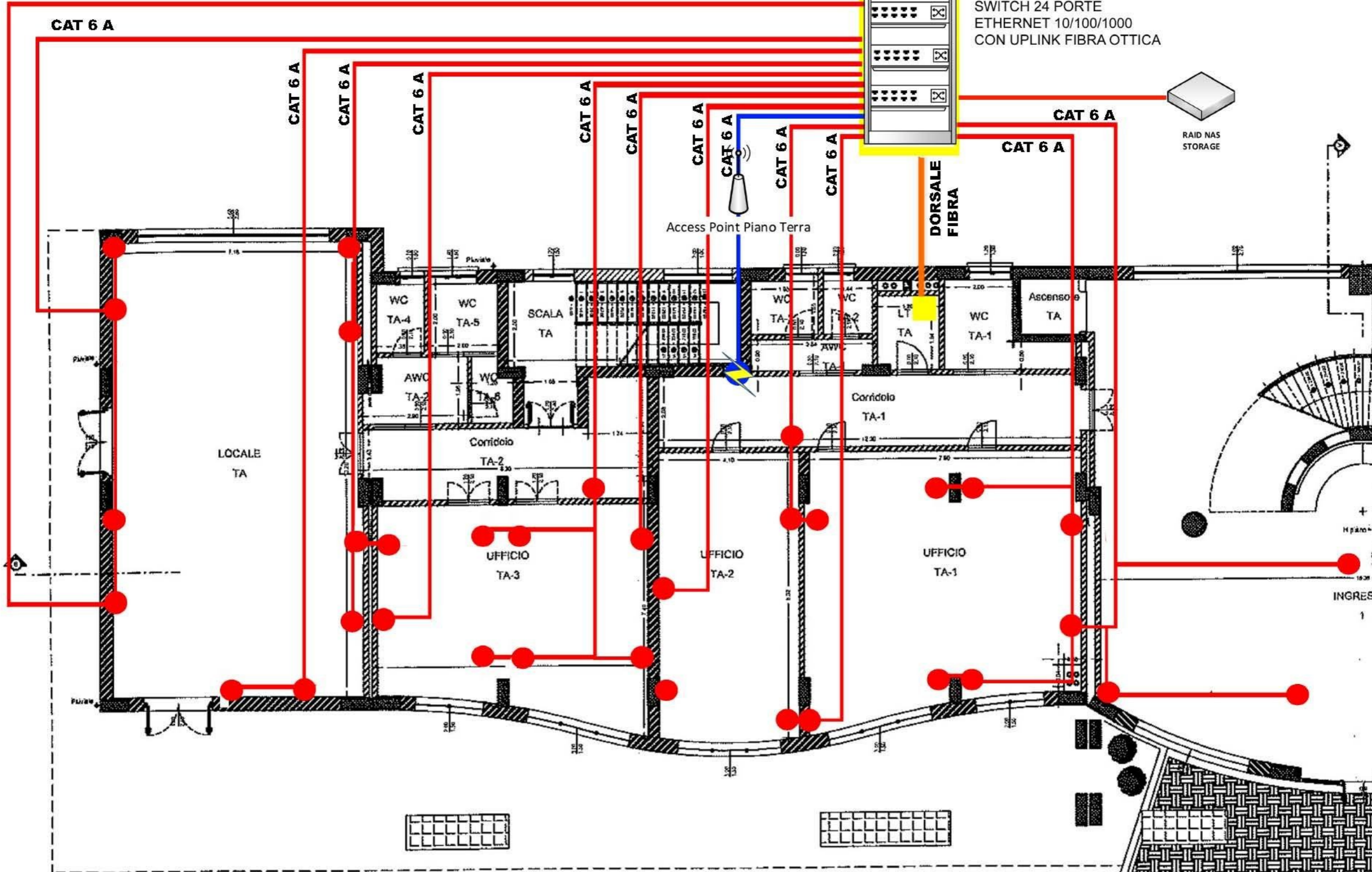

Planimetria Piano Terra - Ala Sinistra  
rete lan

**ARMADIO SWITCH PIANO TERRA ALA DX**

SWITCH 24 PORTE  
ETHERNET 10/100/1000  
CON UPLINK FIBRA OTTICA

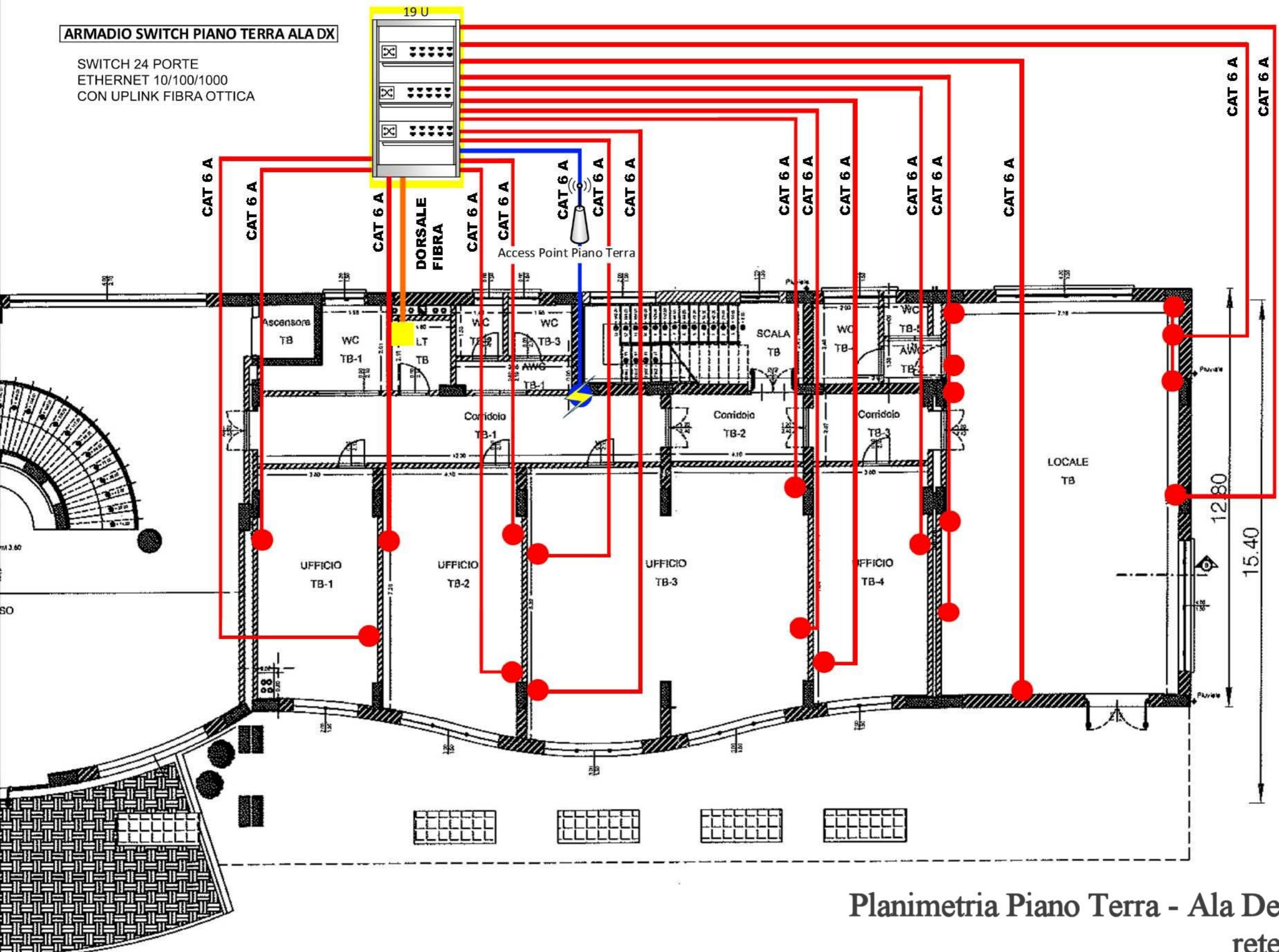

Planimetria Piano Terra - Ala Destra rete lan

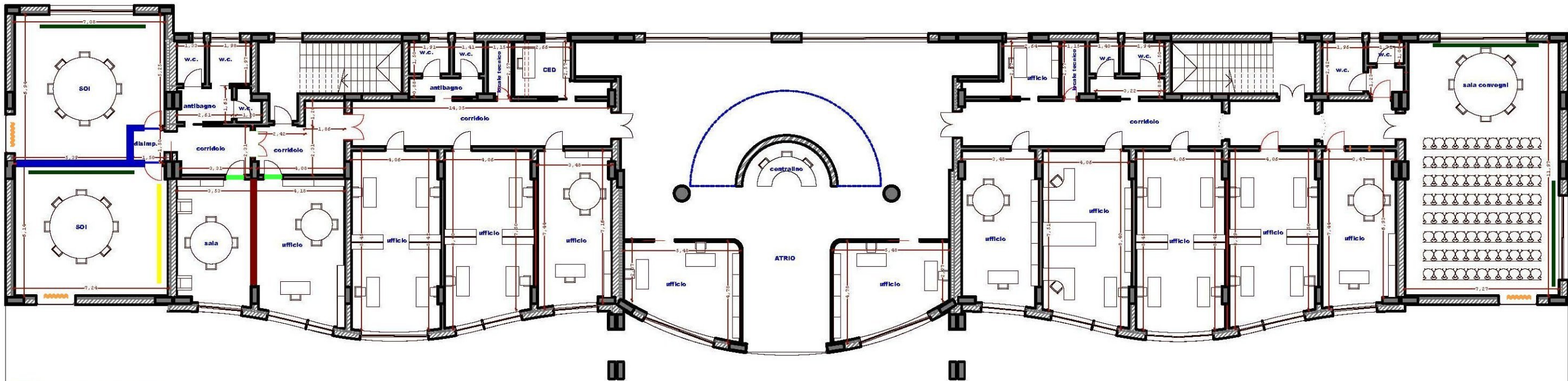

- Parete divisoria in vetro con porte
- Parete divisoria attrezzata con armadi e porta
- Porta di sicurezza antisfondamento
- Tenda motorizzata oscurante
- Schermo motorizzato per proiezioni (SMA)
- Tende veneziane

**Planimetria Piano Terra**  
**Disposizione pareti, porte, schermo e tende**